

CV Dimmers with DALI



Areas of application

- Suitable for indoor installations
- Separate installation (ceiling mounting)

Product family benefits

- Very precise dimming thanks to digital light control

Product family features

- Intelligent digital dimmer (DALI) with constant output voltage
- Dimming range: 0...100 %
- Device fits also for special applications where dimming below 1 % is required

Product family datasheet

Technical data

Electrical data

Product description	Nominal input voltage	Mains frequency	Nominal output voltage	Nominal output power	Galvanic isolation
OTi DALI DIM /10-24	10...24 V	0 Hz	10.5...24 V	120 W	SELV equivalent
OTi DALI DIM 1-4CH D	12...48 V	0 Hz	12...48 V	240 W	SELV

Product description	Output PWM frequency
OTi DALI DIM /10-24	
OTi DALI DIM 1-4CH D	3k Hz

Dimensions & weight

Product description	Mounting hole spacing, length	Mounting length	Product weight	Cable cross-section, input side	Cable cross-section, output side
OTi DALI DIM /10-24	164.0 mm	164.0 mm	75.00 g	0.5...1.5 mm ²	0.5...1.5 mm ²
OTi DALI DIM 1-4CH D	175.5 mm		86.00 g	0.5...2.5 mm ²	0.5...2.5 mm ²

Product description	Wire preparation length, input side	Wire preparation length, output side	Length	Width	Height
OTi DALI DIM /10-24	10 mm	10 mm	172.0 mm	42.0 mm	20.0 mm
OTi DALI DIM 1-4CH D	5...8 mm	5...8 mm	181.0 mm	42.0 mm	20.0 mm

Product family datasheet

Product line drawing

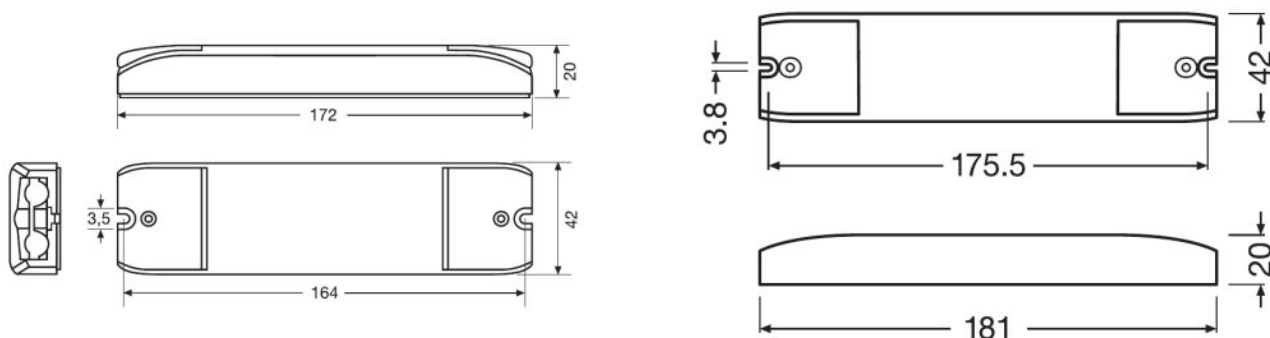

OTi DALI DIM /10-24

OTi DALI DIM 1-4CH D

Colors & materials

Product description	Casing material
OTi DALI DIM /10-24	Plastic
OTi DALI DIM 1-4CH D	Plastic

Temperatures & operating conditions

Product description	Ambient temperature range	Maximum temperature at tc test point	Temperature range at storage	Permitted rel. humidity during operation
OTi DALI DIM /10-24	-20...+50 °C	60 °C	-25...85 °C	5...85 % ¹⁾
OTi DALI DIM 1-4CH D	-20...+50 °C	60 °C	-40...+85 °C	5...85 % ¹⁾

¹⁾ Maximum 56 days/year at 85 %

Lifespan

Product description	ECG lifetime
OTi DALI DIM /10-24	50000 h
OTi DALI DIM 1-4CH D	50000 h

Product family datasheet

Capabilities

Product description	Dimmable	Dimming interface	Dimming range	Dimming method
OTi DALI DIM /10-24	Yes	DALI	0...100 %	Amplitude Modulation / Pulse Width Modulation
OTi DALI DIM 1-4CH D	Yes	DALI-2	0.1...100 %	PWM

Product description	Overheating protection	Overload protection	No-load proof	Suitable for fixtures with prot. class
OTi DALI DIM /10-24	Automatic reversible ¹⁾	Automatic reversible ¹⁾	Yes	II
OTi DALI DIM 1-4CH D	Automatic reversible		Yes	I / II

Product description	Type of connection, output side	Short-circuit protection	Type of connection, input side
OTi DALI DIM /10-24	Screw terminal		
OTi DALI DIM 1-4CH D	Screw terminal	Automatic reversible	Screw terminal

Product description	Number of channels
OTi DALI DIM /10-24	
OTi DALI DIM 1-4CH D	4

¹⁾ In combination with OPTOTRONIC power supply

Certificates & standards

Product description	Approval marks – approval	Standards	Type of protection
OTi DALI DIM /10-24	CE / UR / RCM	Acc. to EC 61347-2-13/Acc. to EN 62384/Acc. to EN 55015/Acc. to EN 61547	IP20
OTi DALI DIM 1-4CH D	CE / EAC / RCM / ENEC 05	Acc. to EC 61347-2-13/Acc. to EN 62384/Acc. to EN 55015/Acc. to EN 61547	IP20

Logistical data

Product description	Commodity code
OTi DALI DIM /10-24	853710989900
OTi DALI DIM 1-4CH D	853710989900

Environmental information

Product description	Date of Declaration	Primary Article Identifier	Candidate List Substance 1
OTi DALI DIM /10-24	23-12-2021	4008321061195	Lead
OTi DALI DIM 1-4CH D	14-01-2022	4062172166010	

Product family datasheet

Product description	CAS No. of substance 1	Safe Use Instruction	Declaration No. in SCIP database
OTi DALI DIM /10-24	7439-92-1	The identification of the Candidate List substance is sufficient to allow safe use of the article.	f18f64d7-b411-4a87-b41f-f22d70fe8f6b
OTi DALI DIM 1-4CH D			In work

Application advice

For more detailed application information and graphics please see product datasheet.









Sales and Technical Support

Sales and Technical Support www.osram.com

Country specific information

Product description	Product code	METEL code	SEG-No.	STK number	UK Org
OTi DALI DIM /10-24	4008321061195	OSROTIDALIDIM	-	4031178	-
OTi DALI DIM /10-24	4008321061195	OSROTIDALIDIM	-	4031178	-

Download Data

File	
	User instruction OPTOTRONIC CONSTANT VOLTAGE dimmers
	Addon Technical Information 313227_ADDON TECHNICAL INFORMATION OTI DALI DIM10-24 VS20 OSRAM (GB)
	Brochures OPTOTRONIC constant-voltage LED power supplies and controls (EN)
	Certificates 20179C1-355535-EN-00
	User instruction OTi DALI DIM 1 4CH D UI
	Product Datasheet Datasheet-OTI DALI DIM 1-4CH D
	Certificates ENEC certificate OTi DALI DIM 1-4CH D
	CAD data 3-dim 3D STEP file

Product family datasheet



CAD data 3-dim
OTi DALI DIM 1-4CH D_ 3D stp file

Logistical Data

Product code	Product description	Packaging unit (Pieces/Unit)	Dimensions (length x width x height)	Volume	Gross weight
4008321061195	OTi DALI DIM /10-24	Shipping carton box 20	351 mm x 77 mm x 222 mm	6.00 dm ³	1780.00 g
4062172166010	OTi DALI DIM 1-4CH D	Shipping carton box 20	229 mm x 197 mm x 133 mm	6.00 dm ³	2088.00 g

The mentioned product code describes the smallest quantity unit which can be ordered. One shipping unit can contain one or more single products. When placing an order, for the quantity please enter single or multiples of a shipping unit.

Disclaimer

Subject to change without notice. Errors and omission excepted. Always make sure to use the most recent release.